



RC2-G/T Series

RC2-G/T Series Screw Compressor



RC2-G&T Series Compressor

Product Description

Newly launched HANBELL RC2-G/T series semi hermetic screw compressor was developed based on RC2 series compressor. The new compressor suitable for high Saturated Discharge Temperature and the newly designed high efficiency motor make the operation range of RC2-G/T series much wider.

RC2-G series belong to high condensing temperature model which is designed for the low waste heat recovery requirement and the R134a refrigerant system, the limit Saturated Discharge Temperature of this new type can reach up to 85 °C .

RC2-T series belong to ultra-high condensing temperature model which is designed for the high waste heat recovery requirement and the R245fa refrigerant system. The limit Saturated Discharge Temperature of this new type can break the limit of traditional compressor and reach up to 125 °C , thus steam can be produced directly.

Nomenclature

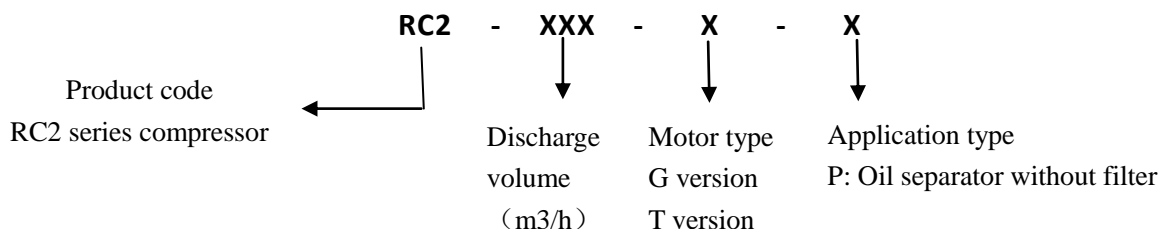

Product Features

High Saturated Discharge Temperature

RC2-G/T series compressor can recover low-grade waste heat resources to produce 70~120°C hot water or steam

RC2-G series compressor consists of 7 models with a discharge range (50Hz) of 100m³/h~790 m³/h, the limit Saturated Discharge Temperature of this series can reach up to 85°C.

RC2-T series compressor consists of 17 models with a discharge range (50Hz) of 200m³/h~930 m³/h, the limit Saturated Discharge Temperature of this series can reach up to 125°C.

High-temperature-resistant motor

Newly designed full series compressor motor which is suitable for R134a、R245fa etc. can ensure high operating efficiency under any load

Long life-time bearing

Selecting matched long life-time bearing based on ultimate operation conditions

Available refrigerants

Available for environment-friendly refrigerants such as R134a and R245fa

Multi-protection system

RC2-G/T can be equipped with new protection module as standard: INT69 HBY Diagnose

The INT69 HBY Diagnose can store the work and error data automatically by keeping the original INT69 HBY phase sequence and over temperature protection. It's only necessary to read the data on the computer through a specific transmission line and use it for diagnostic analysis.

RC2-G/T series compressor is equipped with patented pressure maintenance valves which can help quickly set up enough pressure difference after starting, so that the loading of capacity modulation can be smooth.

RC2-G Production Specification

Model	Compressor					Motor				Strength test (air pressure)	Weight	noise	
	Discharge volume (50Hz)	Rotation speed (50Hz)	Vi valve	Capacity control (%)		Type	Start model	Voltage (50Hz)	Protection				
	m³/h	RPM		Step type	Stepless type			V		Kg/cm²g	Kg	dB	
RC2-100G	98	2950	2.2 3.0 3.5	33, 66, 100	33~100	3 phase 2 pole squirrel cage induction motor	Y-△	380	PTC+ PT100	38	285	73	
RC2-230G	230			25, 50, 75, 100							25~100	577	79
RC2-260G	257											592	79
RC2-410G	407											779	83
RC2-470G	471											825	84
RC2-710G	713											1168	87
RC2-790G	791											1199	87

 **Note:** Select the contactor, power line and fuse protection element according to the rated current and the maximum continuous operation current value of the compressor under various working conditions.

RC2-T Production Specification

Model	Compressor					Motor				Streng th test	Weight	Noise
	Discharg e volume (50Hz)	Rotati on speed (50Hz)	Vi valve	Capacity control (%)		type	Start model	Voltage (50Hz)	Protection			
	m³/h	RPM		step	stepless			V				
RC-2-200T	193	2950	2.2 3.0 3.5	25 50 75 100	25~100	3 phase 2 pole squirrel cage induction motor	Y- △	380	PTC+ PT10 0	35	425	78.4
RC-2-230T	230										535	79
RC-2-260T	257										560	79.2
RC-2-300T	293										600	79.6
RC-2-310T	308										580	79.9
RC-2-340T	339										620	80.4
RC-2-370T	366										640	81.5
RC-2-410T	407										740	83.1
RC-2-470T	471										810	84.2
RC-2-510T	508										780	85.2
RC-2-550T	549										850	86.3
RC-2-580T	583										840	86.6
RC-2-620T	619										880	86.9
RC-2-710T	713										1099	87.1
RC-2-790T	791										1180	87.3
RC-2-830T	825										1215	87.6
RC-2-930T	929	1240	88.4									

RC2-G Performance Form (Without ECO)

RC2-100G, R134a, Performance Data							
Saturated Suction Temp (°C)	Saturated Discharge Temp (°C)	60	65	70	75	80	85
20	Heating Capacity (kw)	108.3	103.6	98.7	93.6	88.4	83.0
	Power (kw)	23.2	25.9	28.8	32.1	35.5	39.1
	COP (H)	4.67	4.00	3.42	2.92	2.49	2.12
25	Heating Capacity (kw)	125.9	120.4	114.7	108.7	102.6	96.4
	Power (kw)	23.4	26.1	29.1	32.4	35.9	39.6
	COP (H)	5.38	4.61	3.94	3.36	2.86	2.43
30	Heating Capacity (kw)	146.2	139.8	133.1	126.1	119.0	111.8
	Power (kw)	23.6	26.3	29.3	32.6	36.2	40.1
	COP (H)	6.20	5.31	4.54	3.87	3.29	2.79
35	Heating Capacity (kw)	169.8	162.2	154.3	146.3	138.1	129.8
	Power (kw)	23.8	26.4	29.5	32.8	36.4	40.3
	COP (H)	7.16	6.12	5.23	4.46	3.79	3.22

RC2-230G, R134a, Performance Data							
Saturated Suction Temp (°C)	Saturated Discharge Temp (°C)	60	65	70	75	80	85
20	Heating Capacity (kw)	273.6	261.2	248.2	234.5	220.4	206.2
	Power (kw)	55.0	61.2	68.2	75.9	84.1	92.6
	COP (H)	4.98	4.27	3.64	3.09	2.62	2.23
25	Heating Capacity (kw)	318.8	304.3	289.0	273.2	256.8	240.1
	Power (kw)	55.4	61.8	68.8	76.5	84.9	93.8
	COP (H)	5.75	4.93	4.20	3.57	3.02	2.56
30	Heating Capacity (kw)	371.1	354.0	336.2	317.8	298.9	279.7
	Power (kw)	55.8	62.3	69.3	77.1	85.6	94.7
	COP (H)	6.65	5.69	4.85	4.12	3.49	2.95
35	Heating Capacity (kw)	431.4	411.3	390.7	369.5	347.8	325.8
	Power (kw)	56.0	62.6	69.7	77.6	86.1	95.3
	COP (H)	7.70	6.57	5.60	4.76	4.04	3.42

★Please download HANBELL selection program to select the oil cooling data according to conditions

★The above data are selected from HANBELL machine selection program 5.0.3.2

RC2-260G, R134a, Performance Data							
Saturated Suction Temp (°C)	Saturated Discharge Temp (°C)	60	65	70	75	80	85
20	Heating Capacity (kw)	284.8	273.7	261.9	249.3	235.3	219.4
	Power (kw)	60.1	64.6	69.6	75.0	80.8	87.1
	COP (H)	4.74	4.24	3.76	3.32	2.91	2.52
25	Heating Capacity (kw)	327.7	314.9	300.7	285.6	269.5	252.3
	Power (kw)	62.6	67.0	71.9	77.2	82.9	89.3
	COP (H)	5.23	4.70	4.18	3.70	3.25	2.83
30	Heating Capacity (kw)	376.0	361.6	344.9	326.8	308.0	288.6
	Power (kw)	65.1	69.2	73.9	79.1	84.8	91.3
	COP (H)	5.78	5.23	4.67	4.13	3.63	3.16
35	Heating Capacity (kw)	436.0	420.1	400.9	379.6	357.4	335.0
	Power (kw)	68.2	72.0	76.4	81.4	87.1	93.8
	COP (H)	6.39	5.84	5.25	4.66	4.10	3.57

RC2-410G, R134a, Performance Data							
Saturated Suction Temp (°C)	Saturated Discharge Temp (°C)	60	65	70	75	80	85
20	Heating Capacity (kw)	461.8	440.3	417.7	394.1	369.7	345.1
	Power (kw)	89.5	99.8	111.2	123.6	137.0	150.9
	COP (H)	5.16	4.41	3.76	3.19	2.70	2.29
25	Heating Capacity (kw)	538.9	513.6	487.2	459.7	431.4	402.6
	Power (kw)	90.3	100.7	112.1	124.7	138.4	152.9
	COP (H)	5.97	5.10	4.35	3.69	3.12	2.63
30	Heating Capacity (kw)	627.8	598.2	567.5	535.7	503.0	469.8
	Power (kw)	91.0	101.5	113.0	125.7	139.5	154.4
	COP (H)	6.90	5.90	5.02	4.26	3.61	3.04
35	Heating Capacity (kw)	730.4	695.8	660.2	623.6	586.2	548.2
	Power (kw)	91.3	102.0	113.6	126.4	140.3	155.4
	COP (H)	8.00	6.82	5.81	4.94	4.18	3.53

★Please download HANBELL selection program to select the oil cooling data according to conditions

★The above data are selected from HANBELL machine selection program 5.0.3.2

RC2-470G, R134a, Performance Data							
Saturated Suction Temp (°C)	Saturated Discharge Temp (°C)	60	65	70	75	80	85
20	Heating Capacity (kw)	535.3	513.7	493.3	470.2	445.8	426.7
	Power (kw)	103.0	113.8	124.2	136.2	150.1	163.6
	COP (H)	5.20	4.51	3.97	3.45	2.97	2.61
25	Heating Capacity (kw)	621.1	593.9	568.7	541.2	512.3	488.0
	Power (kw)	105.4	116.0	126.2	138.3	152.2	166.1
	COP (H)	5.89	5.12	4.51	3.91	3.36	2.94
30	Heating Capacity (kw)	718.6	684.6	653.8	621.4	587.5	557.7
	Power (kw)	108.5	118.4	128.1	139.9	153.9	167.9
	COP (H)	6.62	5.78	5.10	4.44	3.82	3.32
35	Heating Capacity (kw)	830.8	788.7	751.2	712.8	673.2	637.5
	Power (kw)	112.8	121.4	130.1	141.2	154.8	168.6
	COP (H)	7.37	6.50	5.77	5.05	4.35	3.78

RC2-710G, R134a, Performance Data							
Saturated Suction Temp (°C)	Saturated Discharge Temp (°C)	60	65	70	75	80	85
20	Heating Capacity (kw)	800.5	773.0	741.3	710.7	681.0	647.6
	Power (kw)	153.2	168.9	184.8	202.4	221.9	243.0
	COP (H)	5.23	4.58	4.01	3.51	3.07	2.67
25	Heating Capacity (kw)	928.8	891.9	853.4	816.6	780.1	737.5
	Power (kw)	157.5	172.4	188.0	205.6	225.4	247.0
	COP (H)	5.90	5.17	4.54	3.97	3.46	2.99
30	Heating Capacity (kw)	1076.7	1028.5	981.4	937.2	892.9	840.5
	Power (kw)	163.2	176.7	191.4	208.6	228.4	250.3
	COP (H)	6.60	5.82	5.13	4.49	3.91	3.36
35	Heating Capacity (kw)	1243.9	1182.4	1125.1	1072.4	1019.4	956.6
	Power (kw)	170.7	181.9	195.0	211.3	230.7	252.6
	COP (H)	7.29	6.50	5.77	5.08	4.42	3.79

★Please download HANBELL selection program to select the oil cooling data according to conditions

★The above data are selected from HANBELL machine selection program 5.0.3.2

RC2-790G, R134a, Performance Data							
Saturated Suction Temp (°C)	Saturated Discharge Temp (°C)	60	65	70	75	80	85
20	Heating Capacity (kw)	879.0	837.3	793.3	747.0	699.2	651.1
	Power (kw)	164.5	183.3	204.2	227.1	251.7	277.2
	COP (H)	5.34	4.57	3.88	3.29	2.78	2.35
25	Heating Capacity (kw)	1027.0	977.8	926.5	872.9	817.4	761.0
	Power (kw)	166.0	185.0	206.0	229.2	254.3	280.8
	COP (H)	6.19	5.29	4.50	3.81	3.21	2.71
30	Heating Capacity (kw)	1197.6	1139.8	1080.3	1018.6	954.7	889.4
	Power (kw)	167.2	186.5	207.6	230.9	256.3	283.6
	COP (H)	7.16	6.11	5.20	4.41	3.72	3.14
35	Heating Capacity (kw)	1394.6	1327.1	1258.5	1187.7	1114.8	1040.1
	Power (kw)	167.7	187.5	208.8	232.1	257.8	285.6
	COP (H)	8.31	7.08	6.03	5.12	4.32	3.64

★Please download HANBELL selection program to select the oil cooling data according to conditions

★The above data are selected from HANBELL machine selection program 5.0.3.2

RC2-T Performance Form (Without ECO)

RC2-200T,R245fa						
Saturated Discharge Temp℃	Saturated Suction Temp℃	35	45	55	65	75
90	Heating Capacity (kW)	82.6	113.7	155.3	208.8	276
	Power (kW)	22.2	23.4	25.1	27.6	30.7
	COP(H)	3.72	4.86	6.19	7.57	8.99
95	Heating Capacity (kW)	79.8	109.4	149	200.4	265.5
	Power (kW)	24.3	25.6	27.2	29.5	32.2
	COP(H)	3.28	4.27	5.48	6.79	8.25
100	Heating Capacity (kW)	77.5	105.3	142.8	191.7	254.1
	Power (kW)	26.7	28.0	29.6	31.6	34.0
	COP(H)	2.90	3.76	4.82	6.07	7.47
105	Heating Capacity (kW)	75.4	101.3	136.4	182.6	242.1
	Power (kW)	29.3	30.7	32.1	34.0	36.1
	COP(H)	2.57	3.30	4.25	5.37	6.71
110	Heating Capacity (kW)	73.4	97.4	130.1	173.3	229.5
	Power (kW)	32.2	33.6	35.0	36.7	38.5
	COP(H)	2.28	2.90	3.72	4.72	5.96
115	Heating Capacity (kW)	71.4	93.7	124	164.1	216.9
	Power (kW)	35.4	36.8	38.2	39.7	41.3
	COP(H)	2.02	2.55	3.25	4.13	5.25
120	Heating Capacity (kW)	69.6	90.5	118.3	155.5	204.9
	Power (kW)	38.8	40.4	41.7	43.2	44.7
	COP(H)	1.79	2.24	2.84	3.60	4.58
125	Heating Capacity (kW)	-	87.9	113.7	148.0	193.8
	Power (kW)	-	44.3	45.7	47.1	48.5
	COP(H)	-	1.98	2.49	3.14	4.00

RC2-230T,R245fa						
Saturated Discharge Temp℃	Saturated Suction Temp℃	35	45	55	65	75
90	Heating Capacity (kW)	102.9	141.7	193.5	260.2	343.9
	Power (kW)	27.8	29.3	31.5	34.7	38.6
	COP	3.70	4.84	6.14	7.50	8.91
95	Heating Capacity (kW)	99.6	136.4	185.8	249.8	330.9
	Power (kW)	30.5	32.1	34.2	37.0	40.5
	COP	3.27	4.25	5.43	6.75	8.17
100	Heating Capacity (kW)	96.8	131.3	178	238.9	316.7
	Power (kW)	33.5	35.1	37.1	39.7	42.7
	COP	2.89	3.74	4.80	6.02	7.42
105	Heating Capacity (kW)	94.2	126.4	170.1	227.5	301.6
	Power (kW)	36.8	38.5	40.3	42.6	45.2
	COP	2.56	3.28	4.22	5.34	6.67
110	Heating Capacity (kW)	91.6	121.7	162.3	216.1	286.1
	Power (kW)	40.4	42.2	43.9	46.0	48.3
	COP	2.27	2.88	3.70	4.70	5.92
115	Heating Capacity (kW)	89.3	117.1	154.7	204.8	270.5
	Power (kW)	44.4	46.2	47.9	49.9	51.9
	COP	2.01	2.53	3.23	4.10	5.21
120	Heating Capacity (kW)	87.1	113.1	147.8	194.1	255.5
	Power (kW)	48.7	50.7	52.4	54.2	56.1
	COP	1.79	2.23	2.82	3.58	4.55
125	Heating Capacity (kW)	-	109.9	141.9	184.7	241.7
	Power (kW)	-	55.5	57.3	59.2	60.9
	COP(H)	-	1.98	2.48	3.12	3.97

★Please download HANBELL selection program to select the oil cooling data according to conditions

★The above data are selected from HANBELL machine selection program 5.0.3.2

RC2-260T,R245fa						
Saturated Discharge Temp℃	Saturated Suction Temp℃	35	45	55	65	75
90	Heating Capacity (kW)	110.4	152.1	207.7	279.4	369.3
	Power (kW)	29.6	31.2	33.5	36.9	41.0
	COP	3.73	4.88	6.20	7.57	9.01
95	Heating Capacity (kW)	106.7	146.2	199.4	268.2	355.2
	Power (kW)	32.4	34.1	36.3	39.4	43.0
	COP	3.29	4.29	5.49	6.81	8.26
100	Heating Capacity (kW)	103.6	140.8	190.9	256.4	340
	Power (kW)	35.6	37.4	39.4	42.2	45.4
	COP	2.91	3.76	4.85	6.08	7.49
105	Heating Capacity (kW)	100.8	135.5	182.5	244.3	323.8
	Power (kW)	39.1	40.9	42.9	45.4	48.1
	COP	2.58	3.31	4.25	5.38	6.73
110	Heating Capacity (kW)	98.1	130.4	174	231.8	307.1
	Power (kW)	43.0	44.9	46.7	48.9	51.4
	COP	2.28	2.90	3.73	4.74	5.97
115	Heating Capacity (kW)	95.4	125.4	165.8	219.6	290.3
	Power (kW)	47.2	49.2	51.0	53.0	55.2
	COP	2.02	2.55	3.25	4.14	5.26
120	Heating Capacity (kW)	93	121	158.2	208.1	274
	Power (kW)	51.8	53.9	55.7	57.7	59.6
	COP	1.80	2.24	2.84	3.61	4.60
125	Heating Capacity (kW)	-	117.5	152.0	197.9	259.2
	Power (kW)	-	59.1	61.0	62.9	64.8
	COP(H)	-	1.99	2.49	3.15	4.00

RC2-300T,R245fa						
Saturated Discharge Temp℃	Saturated Suction Temp℃	35	45	55	65	75
90	Heating Capacity (kW)	128.4	176.8	241.7	325.0	429.7
	Power (kW)	34.4	36.2	38.9	42.8	47.7
	COP	3.73	4.88	6.21	7.59	9.01
95	Heating Capacity (kW)	124.1	170.1	231.9	311.9	413.2
	Power (kW)	37.7	39.6	42.2	45.7	50
	COP	3.29	4.30	5.5	6.82	8.26
100	Heating Capacity (kW)	120.5	163.7	222.1	298.2	395.4
	Power (kW)	41.4	43.4	45.8	49	52.7
	COP	2.91	3.77	4.85	6.09	7.05
105	Heating Capacity (kW)	117.2	157.6	212.2	284.0	376.6
	Power (kW)	45.4	47.5	49.8	52.7	55.9
	COP	2.58	3.32	4.26	5.39	6.74
110	Heating Capacity (kW)	114	151.5	202.3	269.6	357.1
	Power (kW)	49.9	52.1	54.2	56.8	59.6
	COP	2.28	2.91	3.73	4.75	5.99
115	Heating Capacity (kW)	110.9	145.8	192.8	255.3	337.5
	Power (kW)	54.8	57.1	59.2	61.6	64.1
	COP	2.02	2.55	3.25	4.14	5.26
120	Heating Capacity (kW)	108.1	140.6	184.0	241.9	318.7
	Power (kW)	60.2	62.6	64.7	67.0	69.2
	COP	1.80	2.25	2.84	3.61	4.61
125	Heating Capacity (kW)	-	136.6	176.7	230.1	301.4
	Power (kW)	-	68.6	70.8	73.1	75.2
	COP(H)	-	1.99	2.50	3.15	4.01

★Please download HANBELL selection program to select the oil cooling data according to conditions

★The above data are selected from HANBELL machine selection program 5.0.3.2

RC2-310T,R245fa						
Saturated Discharge Temp℃	Saturated Suction Temp℃	35	45	55	65	75
90	Heating Capacity (kW)	137.2	189.1	258.5	347.6	459.5
	Power (kW)	36.6	38.6	41.5	45.6	50.7
	COP	3.75	4.90	6.23	7.62	9.06
95	Heating Capacity (kW)	132.6	181.8	247.9	333.6	442
	Power (kW)	40.1	42.2	44.9	48.7	53.2
	COP	3.31	4.31	5.52	6.85	8.31
100	Heating Capacity (kW)	128.7	175	237.5	318.9	422.9
	Power (kW)	44.0	46.2	48.8	52.1	56.1
	COP	2.93	3.79	4.87	6.12	7.54
105	Heating Capacity (kW)	125.2	168.3	226.8	303.7	402.8
	Power (kW)	48.4	50.6	53.0	56.1	59.5
	COP	2.59	3.33	4.28	5.41	6.77
110	Heating Capacity (kW)	121.7	161.8	216.2	288.2	381.9
	Power (kW)	53.1	55.4	57.7	60.5	63.5
	COP	2.29	2.92	3.75	4.76	6.01
115	Heating Capacity (kW)	118.4	155.7	206	272.9	360.9
	Power (kW)	58.3	60.8	63.0	65.5	68.2
	COP	2.03	2.56	3.27	4.17	5.29
120	Heating Capacity (kW)	115.4	150.1	196.6	258.5	340.6
	Power (kW)	64.0	66.6	68.9	71.3	73.7
	COP	1.80	2.25	2.85	3.63	4.62
125	Heating Capacity (kW)	-	145.8	188.7	245.8	322.1
	Power (kW)	-	73.0	75.4	77.8	80.1
	COP(H)	-	2.00	2.50	3.16	4.02

RC2-340T,R245fa						
Saturated Discharge Temp℃	Saturated Suction Temp℃	35	45	55	65	75
90	Heating Capacity (kW)	148	204.1	279.1	375.4	496.4
	Power (kW)	39.2	41.4	44.5	48.9	54.4
	COP	3.78	4.93	6.27	7.68	9.13
95	Heating Capacity (kW)	143	196.3	267.7	360.2	477.4
	Power (kW)	43.0	45.3	48.2	52.2	57.1
	COP	3.33	4.33	5.55	6.90	8.36
100	Heating Capacity (kW)	138.8	188.9	256.3	344.3	456.8
	Power (kW)	47.2	49.6	52.3	55.9	60.2
	COP	2.94	3.81	4.90	6.16	7.59
105	Heating Capacity (kW)	135	181.6	244.8	327.8	434.9
	Power (kW)	51.9	54.3	56.9	60.1	63.8
	COP	2.60	3.34	4.30	5.45	6.82
110	Heating Capacity (kW)	131.2	174.5	233.2	311.1	412.3
	Power (kW)	57.0	59.5	61.9	64.9	68.1
	COP	2.30	2.93	3.77	4.79	6.05
115	Heating Capacity (kW)	127.5	167.8	222.2	294.5	389.7
	Power (kW)	62.6	65.2	67.6	70.3	73.2
	COP	2.04	2.57	3.29	4.19	5.32
120	Heating Capacity (kW)	124.2	161.8	212	279	367.7
	Power (kW)	68.7	71.5	73.9	76.5	79.1
	COP	1.81	2.26	2.87	3.65	4.65
125	Heating Capacity (kW)	-	157.0	203.4	265.1	347.6
	Power (kW)	-	78.3	80.9	83.4	85.9
	COP(H)	-	2.01	2.51	3.18	4.05

★Please download HANBELL selection program to select the oil cooling data according to conditions

★The above data are selected from HANBELL machine selection program 5.0.3.2

RC2-370T,R245fa						
Saturated Discharge Temp℃	Saturated Suction Temp℃	35	45	55	65	75
90	Heating Capacity (kW)	161	221.9	303.4	408.1	539.7
	Power (kW)	42.8	45.1	48.5	53.3	59.3
	COP	3.76	4.92	6.26	7.66	9.10
95	Heating Capacity (kW)	155.6	213.5	291.1	391.6	519
	Power (kW)	46.9	49.4	52.5	56.9	62.2
	COP	3.32	4.32	5.54	6.88	8.34
100	Heating Capacity (kW)	151.1	205.3	278.7	374.4	496.6
	Power (kW)	51.5	54.0	57.0	61.0	65.6
	COP	2.93	3.80	4.89	6.14	7.57
105	Heating Capacity (kW)	146.9	197.5	266.2	356.6	472.9
	Power (kW)	56.6	59.2	62.0	65.6	69.6
	COP	2.60	3.34	4.29	5.44	6.79
110	Heating Capacity (kW)	142.7	189.9	253.7	338.3	448.4
	Power (kW)	62.1	64.9	67.5	70.8	74.3
	COP	2.30	2.93	3.76	4.78	6.03
115	Heating Capacity (kW)	138.8	182.6	241.7	320.4	423.7
	Power (kW)	68.2	71.1	73.7	76.7	79.8
	COP	2.04	2.57	3.28	4.18	5.31
120	Heating Capacity (kW)	135.2	176	230.6	303.4	399.9
	Power (kW)	74.9	77.9	80.6	83.4	86.2
	COP	1.81	2.26	2.86	3.64	4.64
125	Heating Capacity (kW)	-	170.9	221.3	288.4	378.1
	Power (kW)	-	85.4	88.2	91.0	93.7
	COP(H)	-	2.00	2.51	3.17	4.04

RC2-410T,R245fa						
Saturated Discharge Temp℃	Saturated Suction Temp℃	35	45	55	65	75
90	Heating Capacity (kW)	180.9	248.9	340.1	457.1	604.2
	Power (kW)	48.8	51.4	55.3	60.8	67.6
	COP	3.71	4.84	6.15	7.52	8.94
95	Heating Capacity (kW)	174.9	239.6	326.4	438.8	581.1
	Power (kW)	53.5	56.3	59.9	64.9	70.9
	COP	3.27	4.26	5.45	6.76	8.20
100	Heating Capacity (kW)	169.9	230.7	312.6	419.6	556.3
	Power (kW)	58.7	61.6	65.0	69.5	74.8
	COP	2.89	3.75	4.81	6.04	7.44
105	Heating Capacity (kW)	165.3	222	298.8	399.7	529.8
	Power (kW)	64.5	67.5	70.7	74.7	79.3
	COP	2.56	3.29	4.23	5.35	6.68
110	Heating Capacity (kW)	160.8	213.5	285	379.6	502.5
	Power (kW)	70.8	73.9	77.0	80.7	84.7
	COP	2.27	2.89	3.70	4.70	5.93
115	Heating Capacity (kW)	156.6	205.5	271.6	359.6	475
	Power (kW)	77.8	81.0	84.0	87.4	90.9
	COP	2.01	2.54	3.23	4.11	5.23
120	Heating Capacity (kW)	152.8	198.4	259.4	340.8	448.7
	Power (kW)	85.4	88.8	91.8	95.0	98.3
	COP	1.79	2.23	2.83	3.59	4.56
125	Heating Capacity (kW)	-	192.9	249.2	324.3	424.5
	Power (kW)	-	97.4	100.5	103.7	106.8
	COP(H)	-	1.98	2.48	3.13	3.97

★Please download HANBELL selection program to select the oil cooling data according to conditions

★The above data are selected from HANBELL machine selection program 5.0.3.2

RC2-470T,R245fa						
Saturated Discharge Temp℃	Saturated Suction Temp℃	35	45	55	65	75
90	Heating Capacity (kW)	210.6	290.8	397.9	535.6	708.6
	Power (kW)	55.0	58.0	62.3	68.5	76.2
	COP	3.83	5.01	6.39	7.82	9.30
95	Heating Capacity (kW)	203.4	279.4	381.6	513.9	681.3
	Power (kW)	60.3	63.4	67.5	73.2	79.9
	COP	3.37	4.41	5.65	7.02	8.53
100	Heating Capacity (kW)	197.3	268.6	365.2	491	651.8
	Power (kW)	66.2	69.4	73.3	78.4	84.3
	COP	2.98	3.87	4.98	6.26	7.73
105	Heating Capacity (kW)	191.5	258.2	348.5	467.2	620.4
	Power (kW)	72.7	76.1	79.7	84.2	89.4
	COP	2.63	3.39	4.37	5.55	6.94
110	Heating Capacity (kW)	186	247.9	331.9	443.1	587.9
	Power (kW)	79.9	83.3	86.8	90.9	95.4
	COP	2.33	2.98	3.82	4.87	6.16
115	Heating Capacity (kW)	180.6	238.1	315.8	419.3	555.2
	Power (kW)	87.7	91.3	94.7	98.5	102.5
	COP	2.06	2.61	3.33	4.26	5.42
120	Heating Capacity (kW)	175.6	229.3	301	396.7	523.7
	Power (kW)	96.2	100.1	103.5	107.1	110.8
	COP	1.83	2.29	2.91	3.70	4.73
125	Heating Capacity (kW)	-	222.3	288.5	376.9	494.8
	Power (kW)	-	109.8	113.3	116.9	120.4
	COP(H)	-	2.02	2.55	3.22	4.11

RC2-510T,R245fa						
Saturated Discharge Temp℃	Saturated Suction Temp℃	35	45	55	65	75
90	Heating Capacity (kW)	227.3	313.7	429.4	578	764.6
	Power (kW)	59.4	62.6	67.3	74.1	82.4
	COP	3.83	5.01	6.38	7.80	9.28
95	Heating Capacity (kW)	219.5	301.5	411.8	554.5	735.1
	Power (kW)	65.1	68.5	73.0	79.1	86.4
	COP	3.37	4.40	5.64	7.01	8.51
100	Heating Capacity (kW)	212.9	289.9	394.1	529.9	703.3
	Power (kW)	71.5	75.0	79.2	84.7	91.1
	COP	2.98	3.87	4.98	6.26	7.72
105	Heating Capacity (kW)	206.8	278.7	376.1	504.2	669.4
	Power (kW)	78.6	82.2	86.1	91.0	96.6
	COP	2.63	3.39	4.37	5.54	6.93
110	Heating Capacity (kW)	200.8	267.7	358.2	478.3	634.4
	Power (kW)	86.3	90.1	93.8	98.3	103.1
	COP	2.33	2.97	3.82	4.87	6.15
115	Heating Capacity (kW)	195	257	340.9	452.6	599.2
	Power (kW)	94.8	98.7	102.3	106.5	110.8
	COP	2.06	2.60	3.33	4.25	5.41
120	Heating Capacity (kW)	189.7	247.6	325	428.3	565.2
	Power (kW)	104.0	108.2	111.9	115.8	119.7
	COP	1.82	2.29	2.90	3.70	4.72
125	Heating Capacity (kW)	-	240.0	311.5	406.8	534.0
	Power (kW)	-	118.6	122.4	126.3	130.1
	COP(H)	-	2.02	2.54	3.22	4.10

★Please download HANBELL selection program to select the oil cooling data according to conditions

★The above data are selected from HANBELL machine selection program 5.0.3.2

RC2-550T,R245fa						
Saturated Discharge Temp℃	Saturated Suction Temp℃	35	45	55	65	75
90	Heating Capacity (kW)	244.7	337.6	461.9	621.7	822.3
	Power (kW)	64.2	67.7	72.7	80.0	89.0
	COP	3.81	4.99	6.35	7.77	9.24
95	Heating Capacity (kW)	236.4	324.5	443	596.4	790.6
	Power (kW)	70.4	74.0	78.8	85.4	93.3
	COP	3.36	4.39	5.62	6.98	8.47
100	Heating Capacity (kW)	229.3	312.1	423.9	570	756.4
	Power (kW)	77.3	81.1	85.5	91.5	98.4
	COP	2.97	3.85	4.96	6.23	7.69
105	Heating Capacity (kW)	222.7	300	404.8	542.5	720.1
	Power (kW)	84.9	88.8	93.0	98.3	104.4
	COP	2.62	3.38	4.35	5.52	6.90
110	Heating Capacity (kW)	216.2	288.2	385.6	514.5	682.4
	Power (kW)	93.2	97.3	101.3	106.1	111.4
	COP	2.32	2.96	3.81	4.85	6.13
115	Heating Capacity (kW)	210.1	276.8	367	487	644.7
	Power (kW)	102.4	106.6	110.6	115.0	119.7
	COP	2.05	2.60	3.32	4.23	5.39
120	Heating Capacity (kW)	204.4	266.7	349.8	461	608.1
	Power (kW)	112.3	116.9	120.8	125.1	129.3
	COP	1.82	2.28	2.90	3.69	4.70
125	Heating Capacity (kW)	-	258.6	335.5	437.9	574.7
	Power (kW)	-	128.1	132.3	136.5	140.5
	COP(H)	-	2.02	2.54	3.21	4.09

RC2-580T,R245fa						
Saturated Discharge Temp℃	Saturated Suction Temp℃	35	45	55	65	75
90	Heating Capacity (kW)	264.7	365.2	499.5	672.2	888.9
	Power (kW)	69.8	73.6	79.1	87.1	96.8
	COP	3.79	4.96	6.31	7.72	9.18
95	Heating Capacity (kW)	255.9	351.1	479.2	644.9	854.7
	Power (kW)	76.6	80.6	85.8	92.9	101.5
	COP	3.34	4.36	5.59	6.94	8.42
100	Heating Capacity (kW)	248.3	337.8	458.7	616.3	817.8
	Power (kW)	84.1	88.2	93.1	99.5	107.1
	COP	2.95	3.83	4.93	6.19	7.64
105	Heating Capacity (kW)	241.1	324.7	437.9	586.8	778.7
	Power (kW)	92.3	96.6	101.2	107.0	113.6
	COP	2.61	3.36	4.33	5.48	6.85
110	Heating Capacity (kW)	234.3	312	417.2	556.7	738
	Power (kW)	101.4	105.9	110.2	115.5	121.2
	COP	2.31	2.95	3.79	4.82	6.09
115	Heating Capacity (kW)	227.8	299.8	397.3	526.9	697.3
	Power (kW)	111.4	116.0	120.3	125.1	130.2
	COP	2.04	2.58	3.30	4.21	5.36
120	Heating Capacity (kW)	221.7	289	378.9	498.9	657.9
	Power (kW)	122.2	127.2	131.5	136.1	140.7
	COP	1.81	2.27	2.88	3.67	4.68
125	Heating Capacity (kW)	-	280.4	363.4	474.1	621.8
	Power (kW)	-	139.4	143.9	148.5	152.9
	COP(H)	-	2.01	2.53	3.19	4.07

★Please download HANBELL selection program to select the oil cooling data according to conditions

★The above data are selected from HANBELL machine selection program 5.0.3.2

RC2-620T,R245fa						
Saturated Discharge Temp℃	Saturated Suction Temp℃	35	45	55	65	75
90	Heating Capacity (kW)	276.5	381.5	522	702.6	929.6
	Power (kW)	72.4	76.3	82.0	90.2	100.4
	COP	3.82	5.00	6.37	7.79	9.26
95	Heating Capacity (kW)	267.1	366.7	500.7	674.1	893.7
	Power (kW)	79.4	83.5	88.9	96.3	105.3
	COP	3.36	4.39	5.63	7.00	8.49
100	Heating Capacity (kW)	258.9	352.6	479.2	644.2	855
	Power (kW)	87.1	91.4	96.5	103.2	111.0
	COP	2.97	3.86	4.97	6.24	7.70
105	Heating Capacity (kW)	251.5	338.9	457.4	613.1	813.9
	Power (kW)	95.7	100.1	104.9	110.9	117.7
	COP	2.63	3.39	4.36	5.53	6.92
110	Heating Capacity (kW)	244.2	325.5	435.7	581.5	771.3
	Power (kW)	105.1	109.7	114.3	119.7	125.6
	COP	2.32	2.97	3.81	4.86	6.14
115	Heating Capacity (kW)	237.3	312.7	414.6	550.3	728.5
	Power (kW)	115.5	120.3	124.7	129.7	134.9
	COP	2.05	2.60	3.32	4.24	5.40
120	Heating Capacity (kW)	230.9	301.2	395.3	520.8	687.2
	Power (kW)	126.7	131.8	136.3	141.0	145.8
	COP	1.82	2.29	2.90	3.69	4.71
125	Heating Capacity (kW)	-	292.1	378.9	494.7	649.4
	Power (kW)	-	144.5	149.2	153.9	158.5
	COP(H)	-	2.02	2.54	3.21	4.10

RC2-710T,R245fa						
Saturated Discharge Temp℃	Saturated Suction Temp℃	35	45	55	65	75
90	Heating Capacity (kW)	320.8	442.7	605.7	815.4	1078.5
	Power (kW)	84.0	88.6	95.2	104.8	116.5
	COP	3.82	5.00	6.36	7.78	9.26
95	Heating Capacity (kW)	309.8	425.5	581	782.2	1037
	Power (kW)	92.1	96.9	103.2	111.8	122.2
	COP	3.36	4.39	5.63	7.00	8.49
100	Heating Capacity (kW)	300.5	409.2	556	747.5	992
	Power (kW)	101.1	106.1	112.0	119.8	128.8
	COP	2.97	3.86	4.96	6.24	7.70
105	Heating Capacity (kW)	291.9	393.3	530.8	711.4	944.3
	Power (kW)	111.1	116.2	121.8	128.7	136.6
	COP	2.63	3.38	4.36	5.53	6.91
110	Heating Capacity (kW)	283.4	377.8	505.5	674.8	894.9
	Power (kW)	122.0	127.4	132.6	139.0	145.8
	COP	2.32	2.97	3.81	4.85	6.14
115	Heating Capacity (kW)	275.3	362.9	481.1	638.6	845.3
	Power (kW)	134.0	139.6	144.7	150.6	156.6
	COP	2.05	2.60	3.32	4.24	5.40
120	Heating Capacity (kW)	268	349.5	458.7	604.3	797.4
	Power (kW)	147.1	153.0	158.2	163.7	169.3
	COP	1.82	2.28	2.90	3.69	4.71
125	Heating Capacity (kW)	-	338.9	439.7	574.1	753.5
	Power (kW)	-	167.8	173.1	178.6	183.9
	COP(H)	-	2.02	2.54	3.21	4.10

★Please download HANBELL selection program to select the oil cooling data according to conditions

★The above data are selected from HANBELL machine selection program 5.0.3.2

RC2-790T,R245fa						
Saturated Discharge Temp °C	Saturated Suction Temp °C	35	45	55	65	75
90	Heating Capacity (kW)	355.4	490.6	671.4	903.8	1195.6
	Power (kW)	92.9	97.9	105.3	115.8	128.8
	COP	3.83	5.01	6.38	7.80	9.28
95	Heating Capacity (kW)	343.2	471.6	643.9	867	1149.5
	Power (kW)	101.8	107.2	114.1	123.6	135.1
	COP	3.37	4.40	5.64	7.01	8.51
100	Heating Capacity (kW)	332.9	453.4	616.1	828.5	1099.6
	Power (kW)	111.8	117.3	123.8	132.4	142.4
	COP	2.98	3.87	4.98	6.26	7.72
105	Heating Capacity (kW)	323.2	435.7	588.1	788.4	1046.8
	Power (kW)	122.8	128.5	134.6	142.3	151.1
	COP	2.63	3.39	4.37	5.54	6.93
110	Heating Capacity (kW)	313.9	418.4	560.1	747.8	991.9
	Power (kW)	134.9	140.8	146.6	153.6	161.2
	COP	2.33	2.97	3.82	4.87	6.15
115	Heating Capacity (kW)	304.9	401.9	533	707.6	936.9
	Power (kW)	148.2	154.3	160.0	166.5	173.2
	COP	2.06	2.60	3.33	4.25	5.41
120	Heating Capacity (kW)	296.6	387.1	508.1	669.6	883.7
	Power (kW)	162.6	169.2	174.9	181.0	187.1
	COP	1.82	2.29	2.91	3.70	4.72
125	Heating Capacity (kW)	-	375.3	487.0	636.0	834.9
	Power (kW)	-	185.5	191.4	197.5	203.4
	COP(H)	-	2.02	2.54	3.22	4.10

RC2-830T,R245fa						
Saturated Discharge Temp °C	Saturated Suction Temp °C	35	45	55	65	75
90	Heating Capacity (kW)	380.4	525.1	718.7	967.4	1279.9
	Power (kW)	99.3	104.7	112.6	123.8	137.7
	COP	3.83	5.02	6.38	7.81	9.29
95	Heating Capacity (kW)	367.4	504.7	689.2	928.1	1230.5
	Power (kW)	108.9	114.6	122.0	132.2	144.4
	COP	3.37	4.40	5.65	7.02	8.52
100	Heating Capacity (kW)	356.2	485.2	659.5	886.9	1177.2
	Power (kW)	119.5	125.4	132.4	141.6	152.3
	COP	2.98	3.87	4.98	6.26	7.73
105	Heating Capacity (kW)	345.9	466.3	629.4	844	1120.5
	Power (kW)	131.3	137.4	143.9	152.2	161.5
	COP	2.63	3.39	4.37	5.55	6.94
110	Heating Capacity (kW)	335.9	447.8	599.5	800.4	1061.8
	Power (kW)	144.3	150.5	156.8	164.3	172.4
	COP	2.33	2.98	3.82	4.87	6.16
115	Heating Capacity (kW)	326.2	430.1	570.5	757.4	1002.9
	Power (kW)	158.4	165.0	171.1	178.0	185.2
	COP	2.06	2.61	3.33	4.26	5.42
120	Heating Capacity (kW)	317.4	414.2	543.7	716.6	945.9
	Power (kW)	173.9	180.9	187.0	193.5	200.1
	COP	1.83	2.29	2.91	3.70	4.73
125	Heating Capacity (kW)	-	401.5	521.2	680.7	893.6
	Power (kW)	-	198.3	204.7	211.2	217.4
	COP(H)	-	2.02	2.55	3.22	4.11

★Please download HANBELL selection program to select the oil cooling data according to conditions

★The above data are selected from HANBELL machine selection program 5.0.3.2

RC2-930T,R245fa						
Saturated Discharge Temp °C	Saturated Suction Temp °C	35	45	55	65	75
90	Heating Capacity (kW)	425.2	587.2	803.6	1081.9	1431.3
	Power (kW)	110.8	116.9	125.6	138.2	153.7
	COP	3.84	5.02	6.40	7.83	9.31
95	Heating Capacity (kW)	410.7	564.3	770.6	1037.8	1376.1
	Power (kW)	121.5	127.9	136.1	147.5	161.2
	COP	3.38	4.41	5.66	7.04	8.54
100	Heating Capacity (kW)	398.2	542.5	737.4	991.6	1316.3
	Power (kW)	133.4	140.0	147.8	158.0	169.9
	COP	2.99	3.88	4.99	6.28	7.75
105	Heating Capacity (kW)	386.6	521.3	703.8	943.7	1253
	Power (kW)	146.6	153.3	160.7	169.9	180.3
	COP	2.64	3.40	4.38	5.55	6.95
110	Heating Capacity (kW)	375.4	500.5	670.2	894.9	1187.3
	Power (kW)	161.0	168.0	175.0	183.3	192.4
	COP	2.33	2.98	3.83	4.88	6.17
115	Heating Capacity (kW)	364.5	480.7	637.7	846.7	1121.3
	Power (kW)	176.8	184.2	191.0	198.6	206.7
	COP	2.06	2.61	3.34	4.26	5.42
120	Heating Capacity (kW)	354.5	462.9	607.7	801.2	1057.5
	Power (kW)	194.0	201.9	208.7	216.0	223.3
	COP	1.83	2.29	2.91	3.71	4.74
125	Heating Capacity (kW)	-	448.6	582.4	760.9	999.1
	Power (kW)	-	221.3	228.4	235.7	242.7
	COP(H)	-	2.03	2.55	3.23	4.12

Remark: The above performance data are in accordance with the latest selection software of Hanbell. The selection software may be updated with prior notice.

RC2-100G Drawing

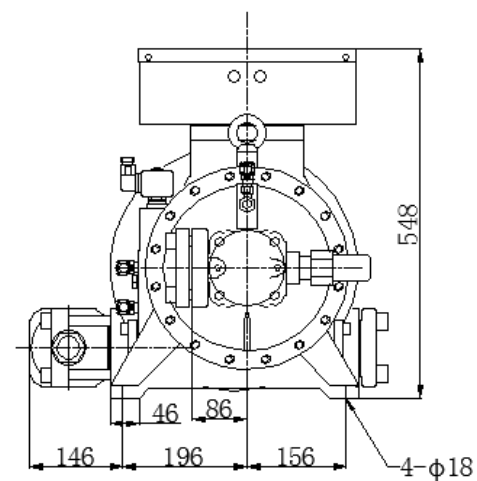
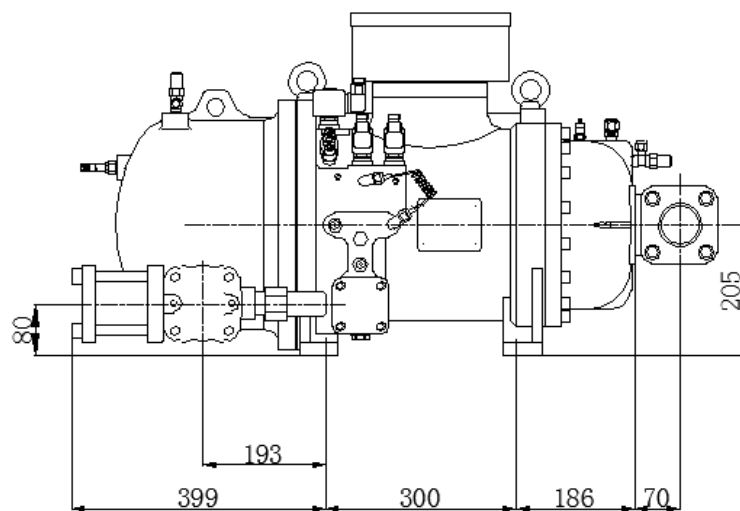
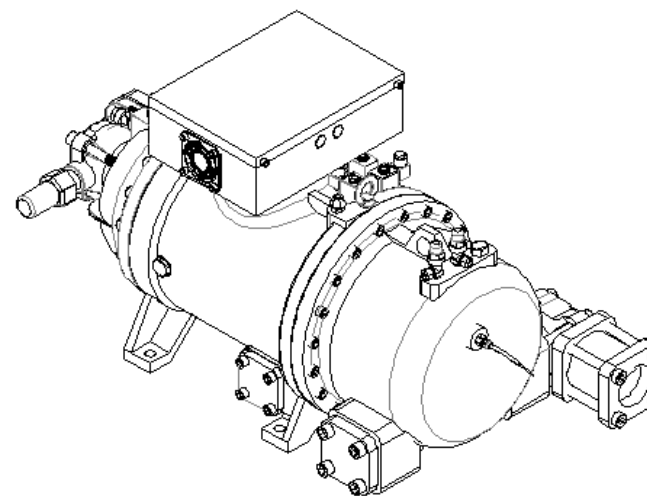
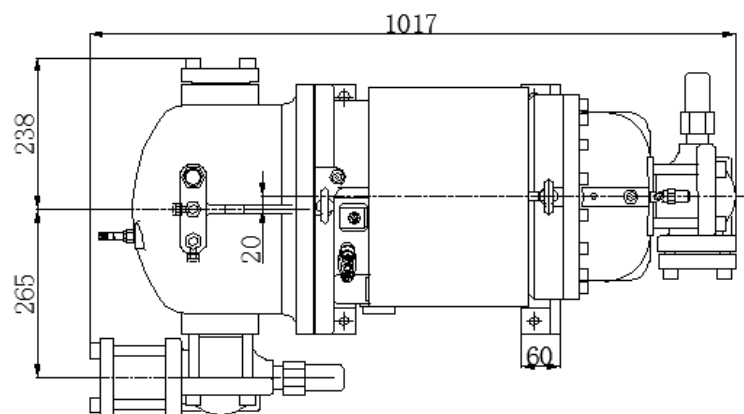

RC2-230G~470G Drawing

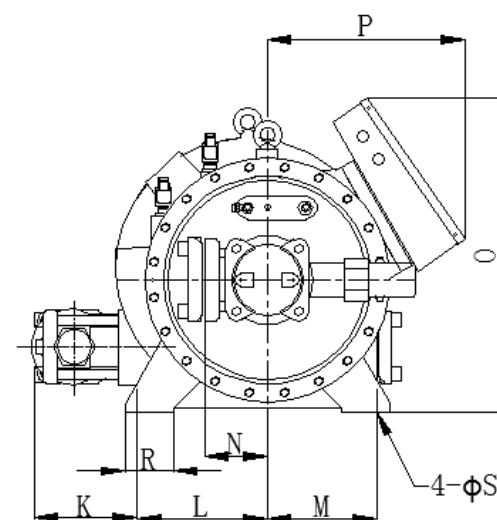
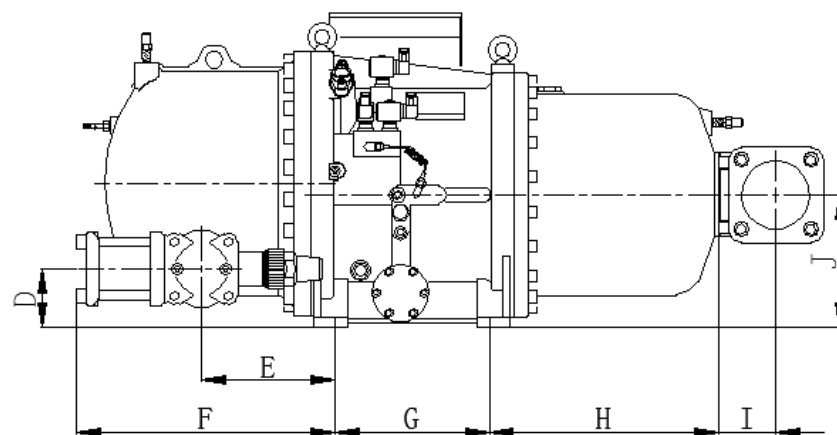
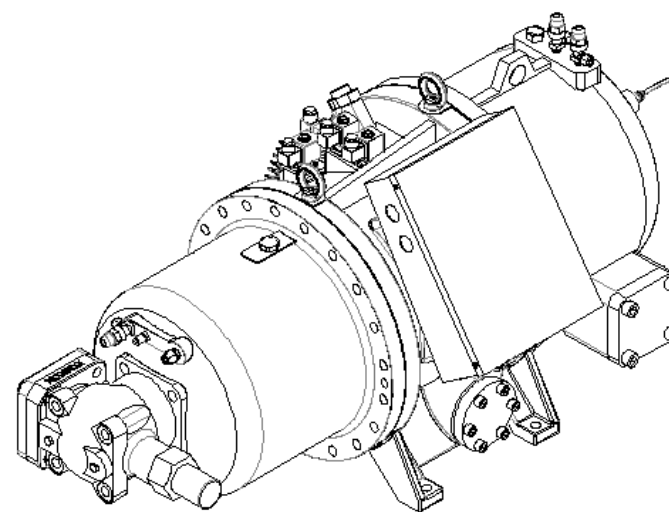
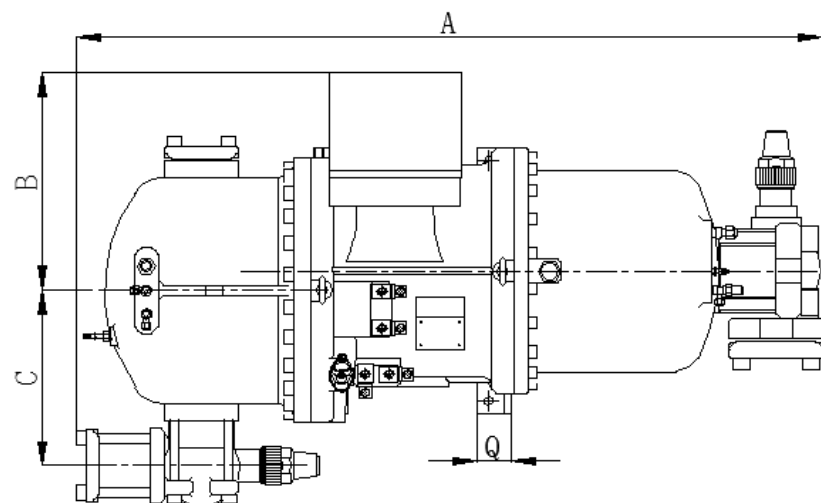

Dimension Table

Model No.	RC2-230G~790G Dimension Unit: mm																		
	A	B	C	D	E	F	G	H	I	J	K	L	M	N	O	P	Q	R	S
RC2-230G RC2-260G	1418	400	326	118	241	452	251	492	100	257	169	240	240	130	622	386	55	48	18
RC2-410G	1509	448	365	122	277	517	288	478	103	275	220	270	230	130	652	408	70	100	22
RC2-470G	1541	448	365	122	277	517	320	478	103	275	220	270	230	130	652	408	70	100	22
RC2-710G	1839	505	379	639	161	185	346	630	353	752	808	124	250	270	230	682	465	--	--
RC2-790G	1905	505	379	639	161	185	348	630	418	752	808	124	250	270	230	682	465	--	--

Remarks: The above data represent the external dimensions of RC2-G compressors.

The above data is only for reference, real size depend on the actual model. Design may be changed without prior notice

RC2-710G~790G Drawing

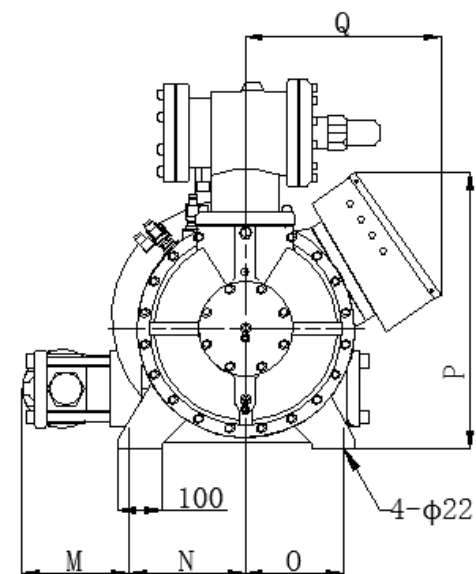
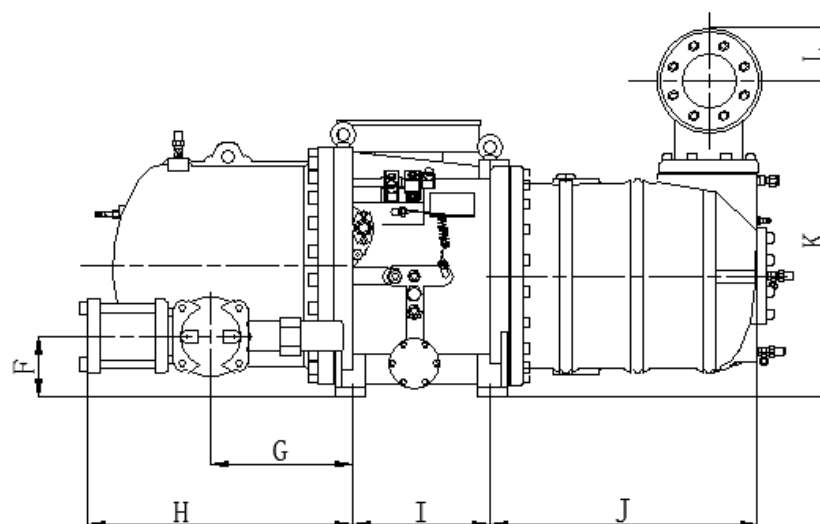
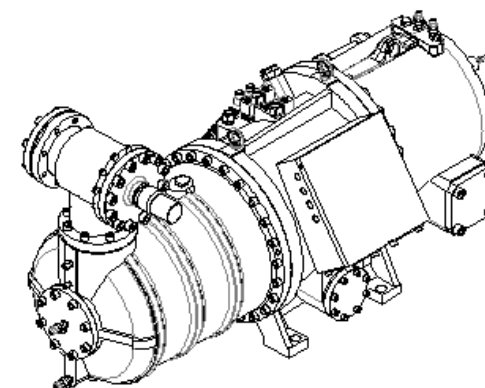
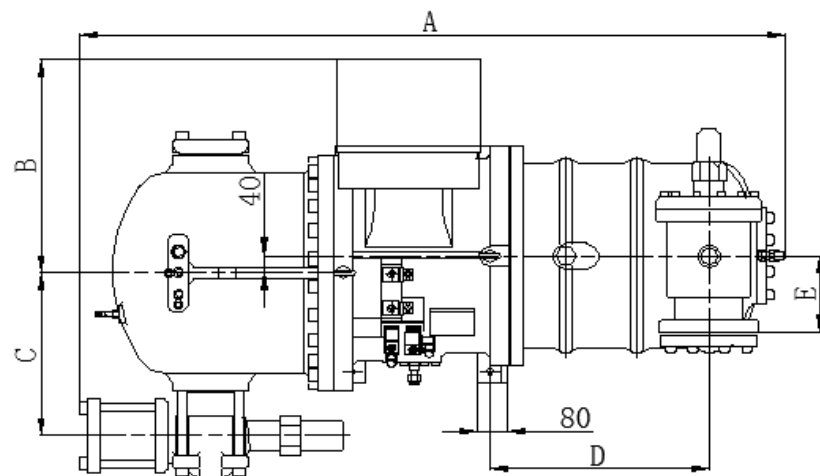

RC2-200T~620T Drawing (Horizontal suction port for 620)

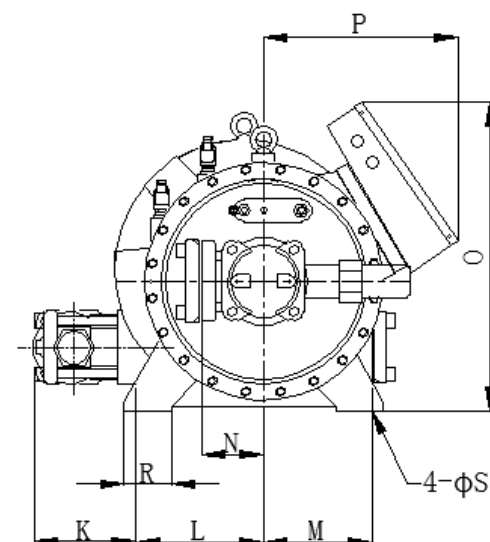
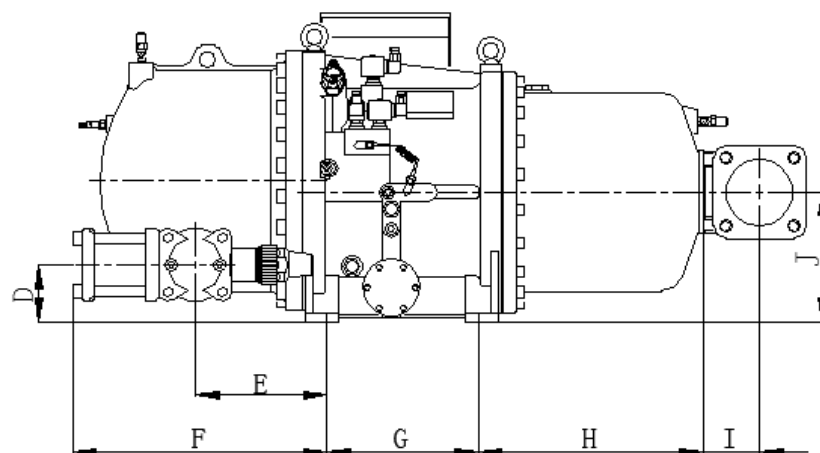
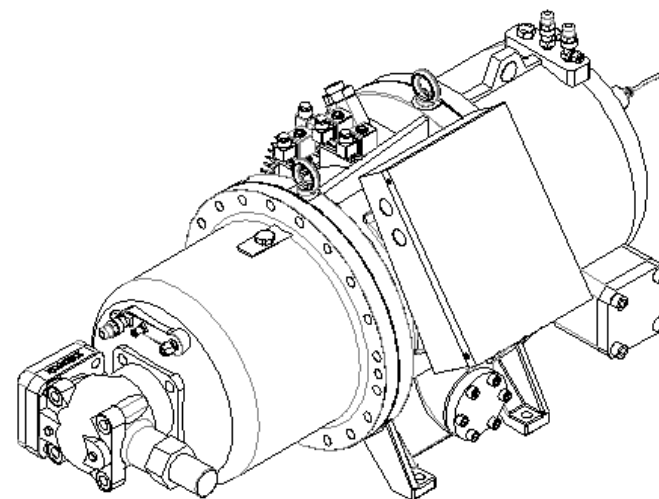
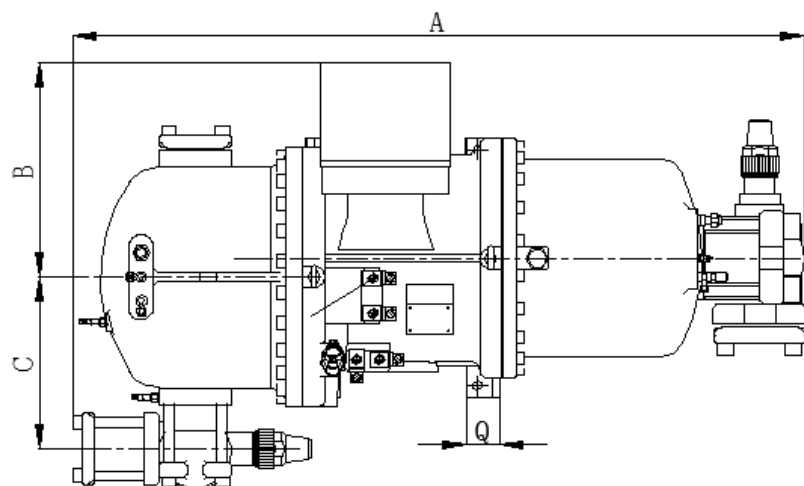

Dimension Table

Model No.	RC2-200T~620T (Horizontal suction port for 620) External dimension Unit: mm																		
	A	B	C	D	E	F	G	H	I	J	K	L	M	N	O	P	Q	R	S
RC2-200T	1188	375	283	103	188	408	228	386	82	225	135	225	225	96	592	362	51	48	18
RC2-230T RC2-260T	1300	400	326	118	241	452	251	399	97	257	169	240	240	107	622	386	55	48	18
RC2-300T	1379	400	326	118	241	452	285	444	97	257	169	240	240	107	622	386	55	48	18
RC2-310T	1352	400	326	118	241	452	251	444	97	257	169	240	240	107	622	386	55	48	18
RC2-340 T RC2-370T	1452	400	326	118	241	452	285	492	103	257	169	240	240	132	622	386	55	48	18
RC2-410T	1463	448	365	122	277	517	288	433	103	275	220	270	230	132	652	408	70	100	22
RC2-470T	1541	448	365	122	277	517	320	478	103	275	220	270	230	132	652	408	70	100	22
RC2-510T	1515	490	365	122	277	517	288	484	103	275	220	270	230	132	638	450	70	100	22
RC2-550T	1593	490	365	126	272	512	320	536	103	280	220	270	230	132	642	450	70	100	22
RC2-580T	1534	490	365	122	277	517	320	484	103	275	220	270	230	132	638	450	70	100	22
RC2-620T	1819	490	379	140	331	615	320	525	220	280	251	270	230	161	642	450	70	100	22

Model No.	RC2-620 T-P~930 T-P Vertical suction port Horizontal oil separator external dimension Unit: mm																	
	A	B	C	D	E	F	G	H	I	J	K	L	M	N	O	P	Q	R
RC2-620T	1657	490	379	510	161	140	331	615	320	623	738	124	251	270	230	642	450	70
RC2-710T	1763	505	379	585	161	185	346	630	353	698	808	124	250	270	230	682	465	80
RC2-790T RC2-830T	1875	509	379	585	161	185	346	630	418	698	808	124	250	270	230	682	465	80
RC2-930T	1906	509	379	639	161	185	346	630	418	752	808	124	250	270	230	682	465	80

Remarks: The above data represent the external dimensions of RC2-T compressors.

The above data is only for reference, real size depend on the actual model. Design may be changed without prior notice

RC2-620T~930T Drawing (Vertical suction port for 620)

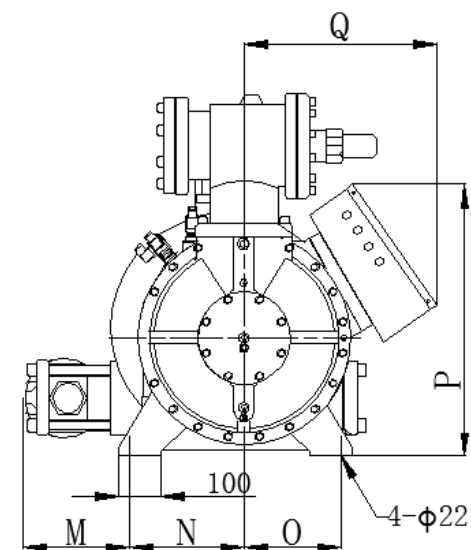
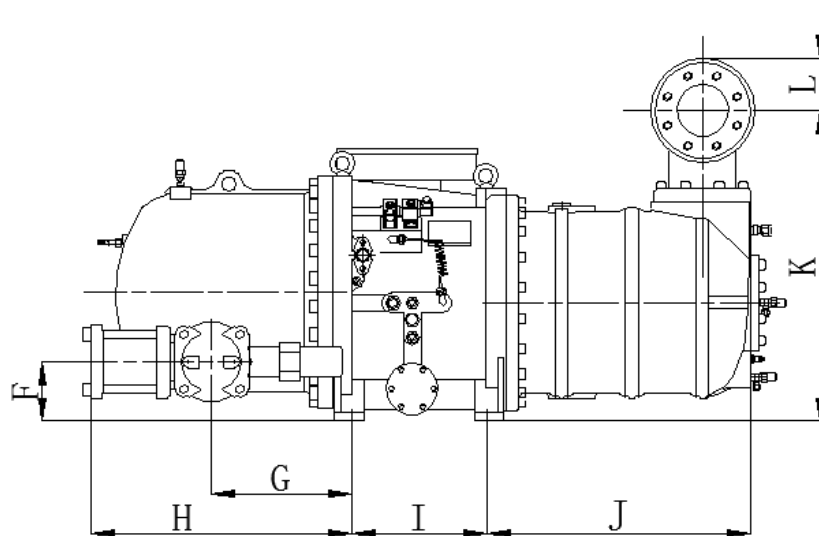
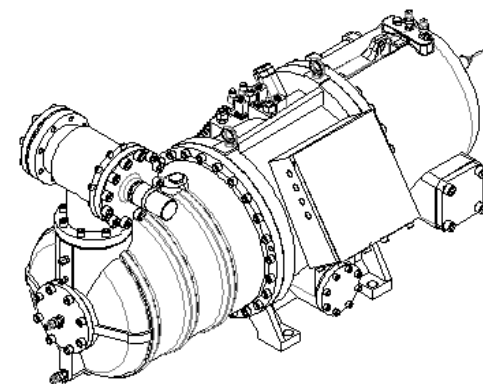
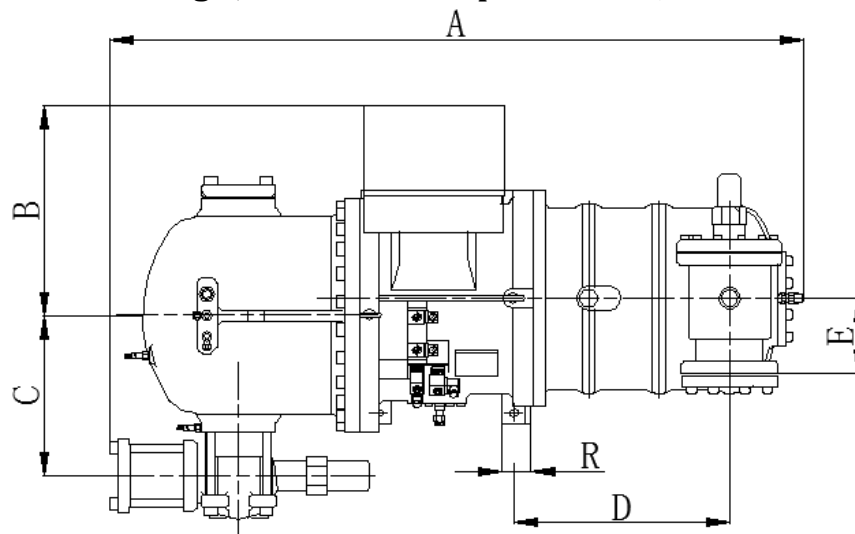

RC2-100G Drawing

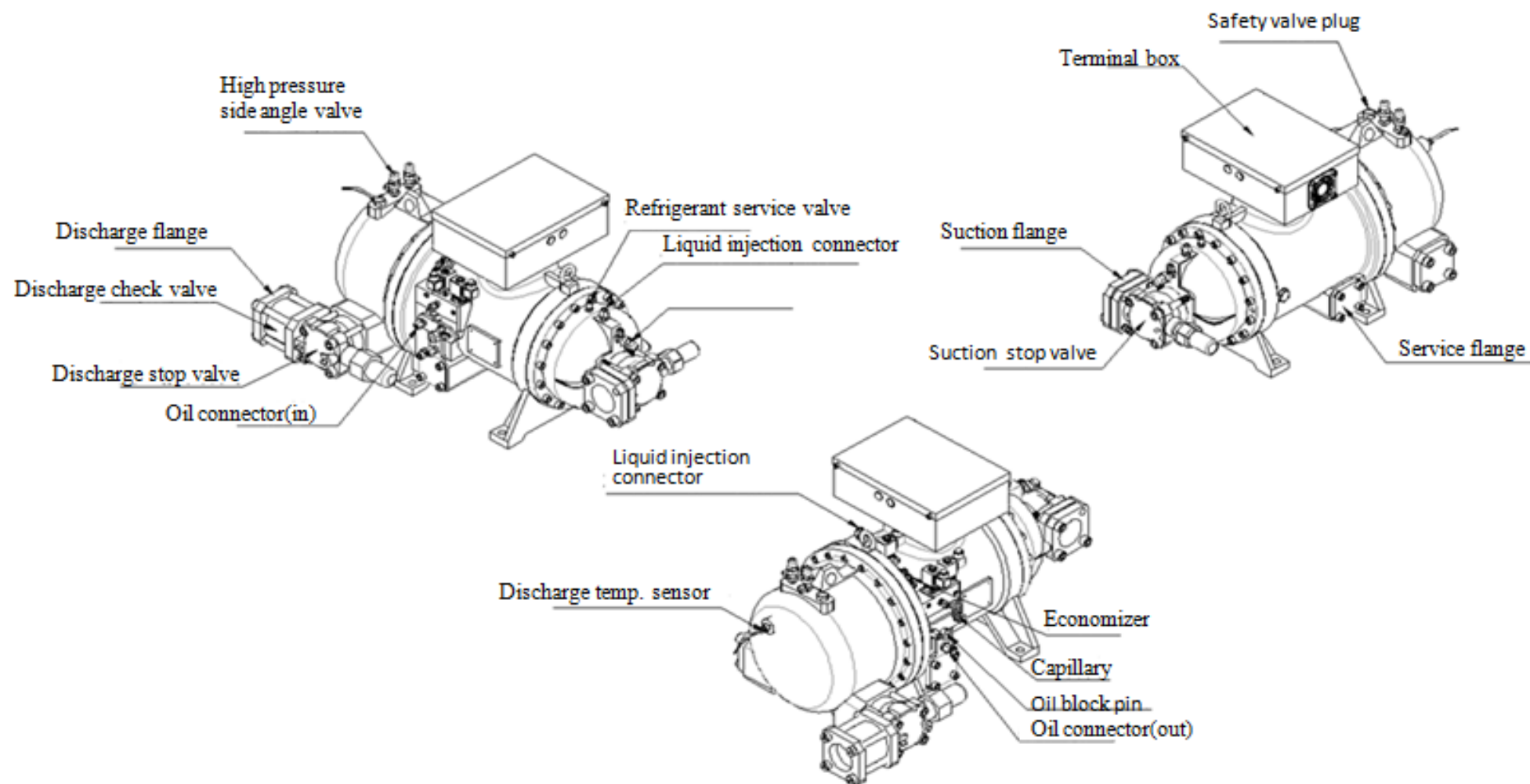

RC2-230G~470G Drawing

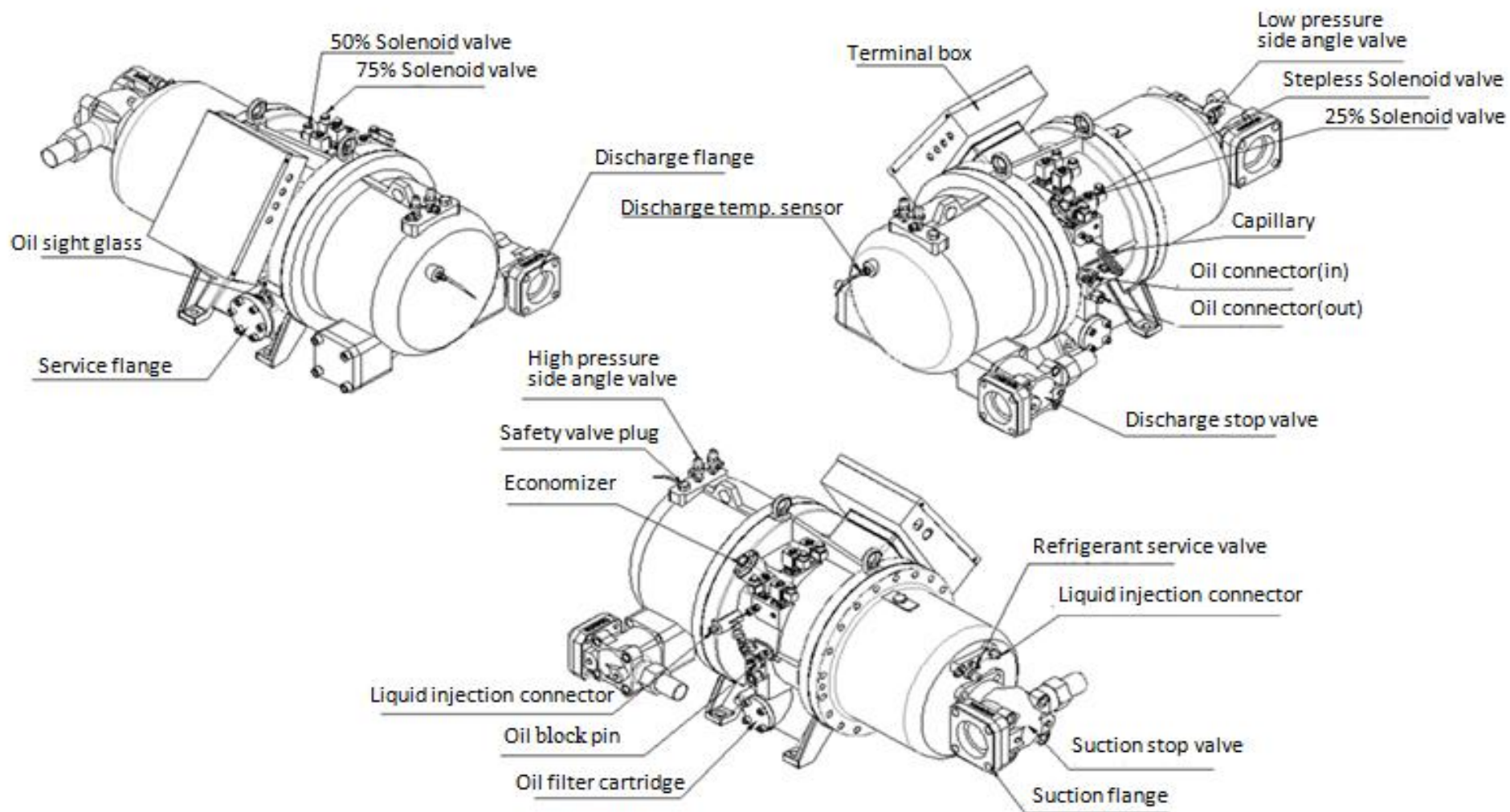

RC2-710G~790G Drawing

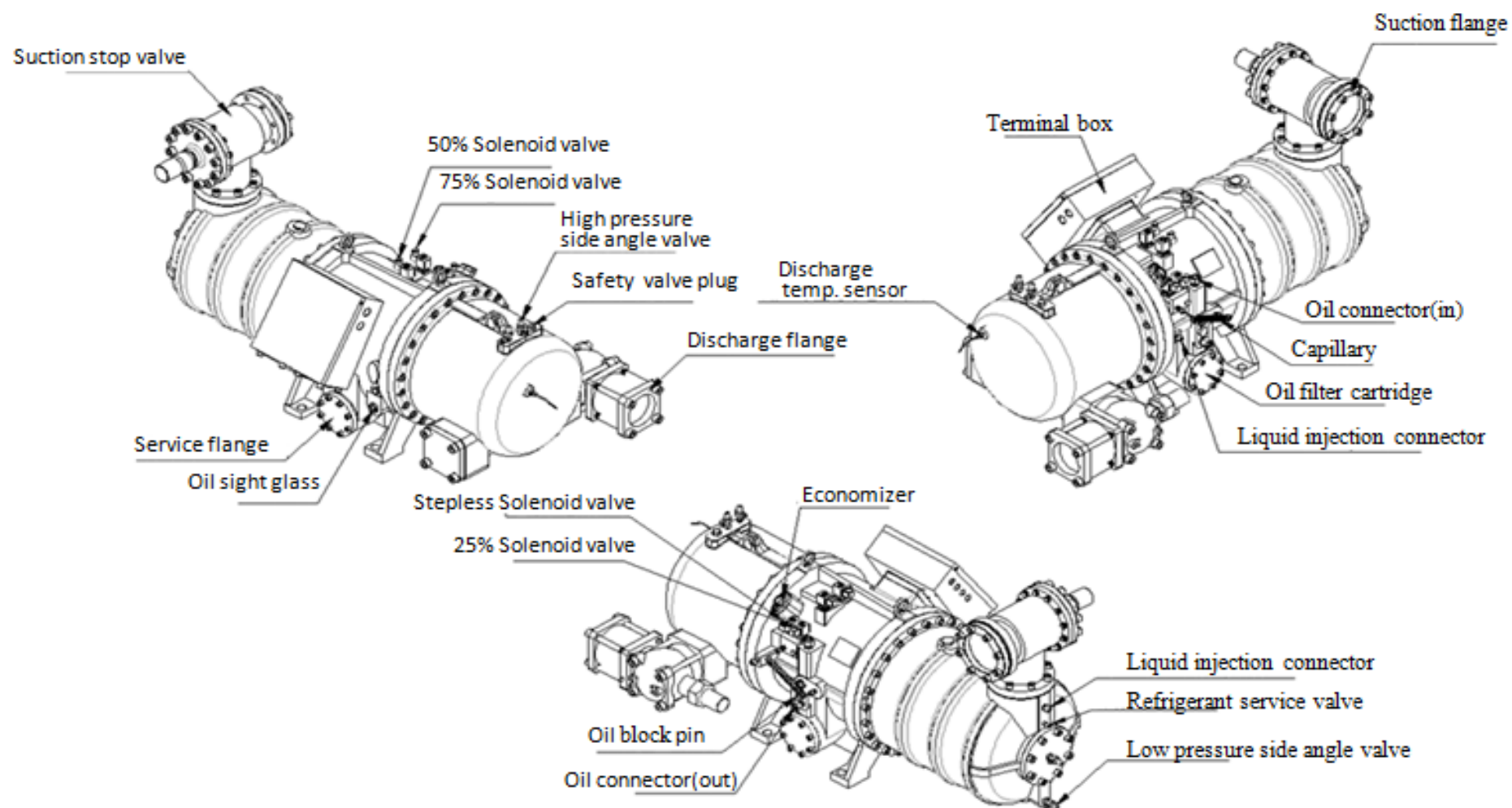

RC2-200T~620T (Horizontal suction port for 620)

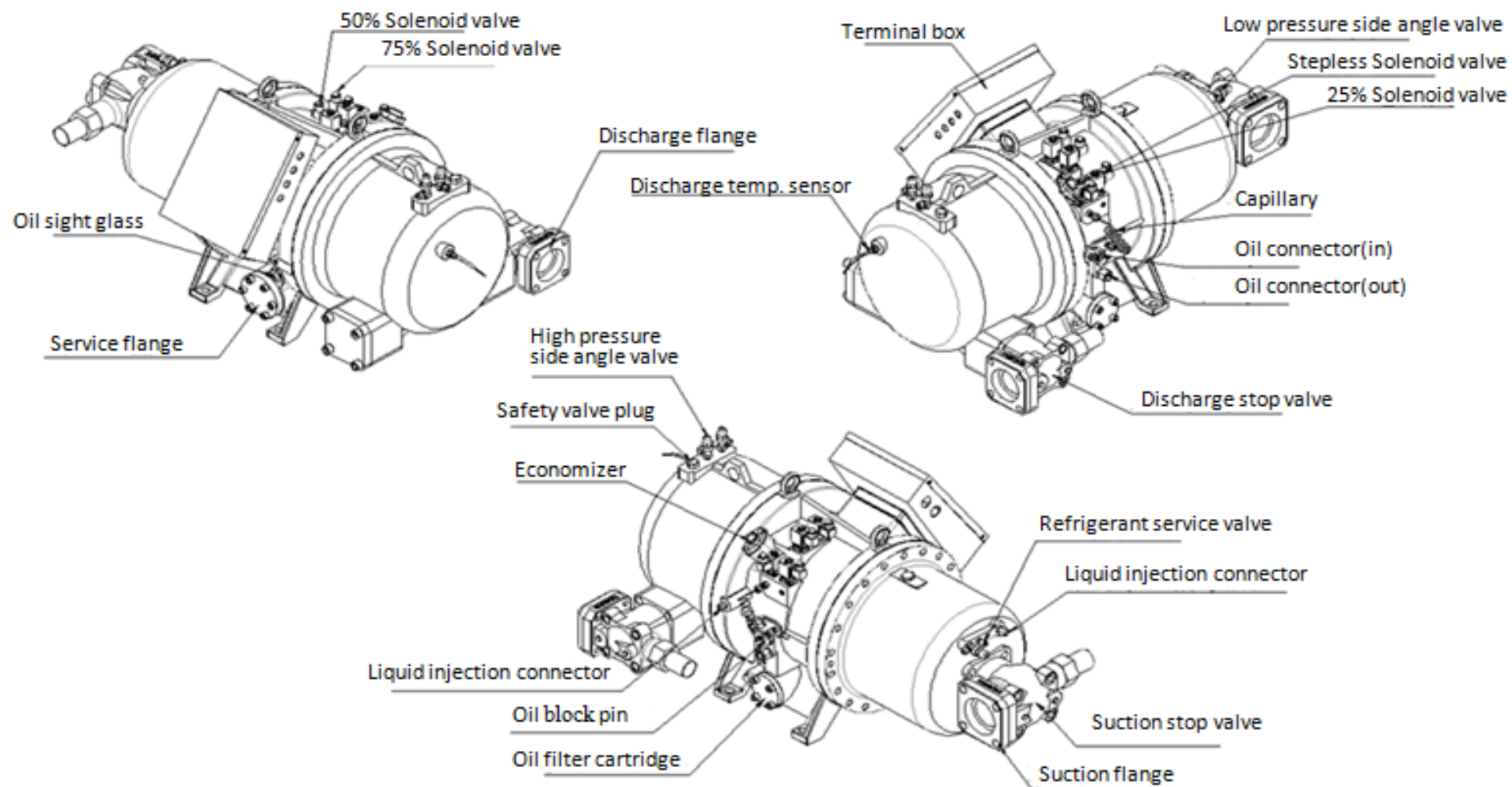

RC2-620T~930T Drawing (Vertical suction port for 620)

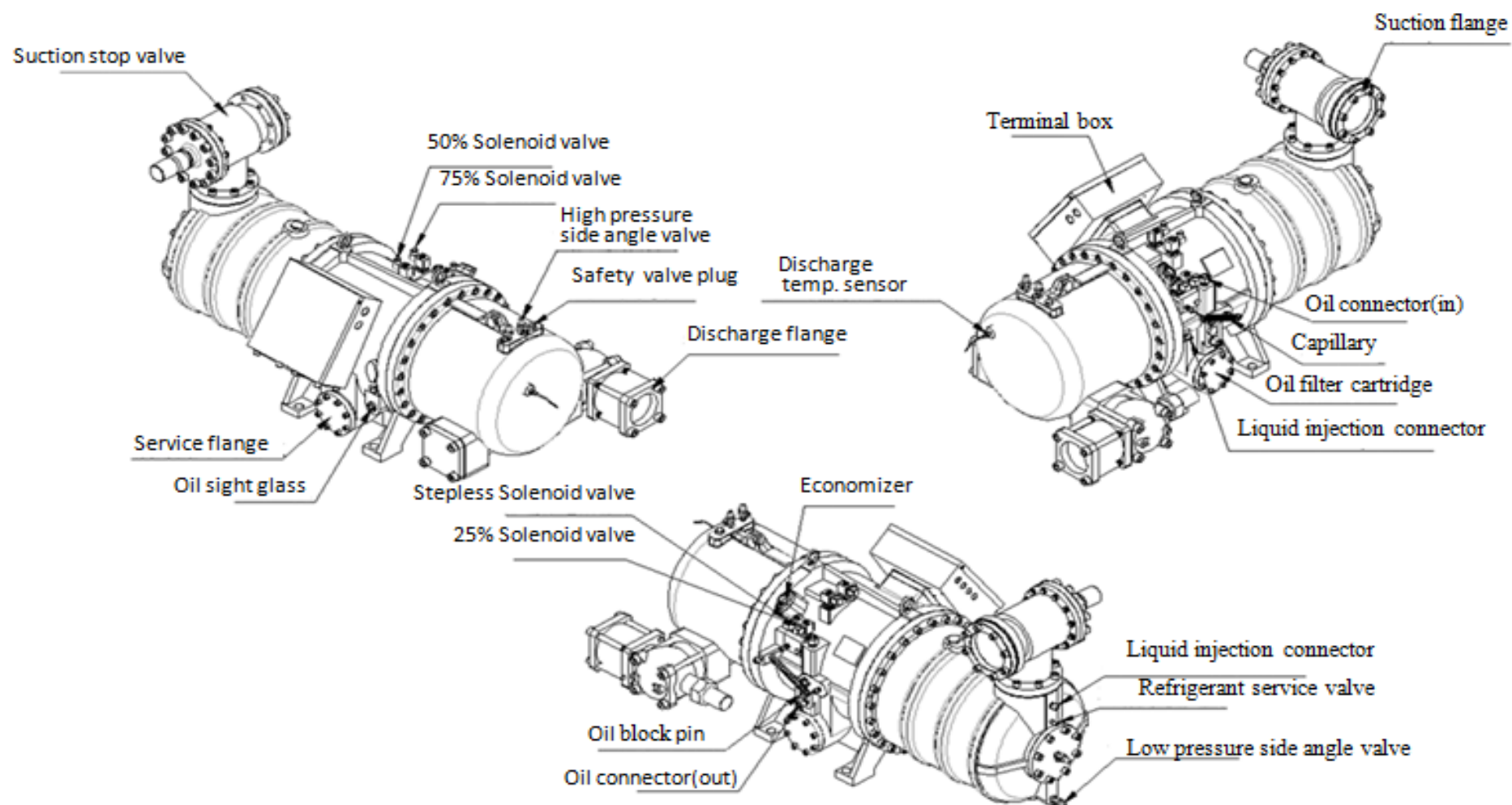

Specification for Suction/ Discharge sleeve

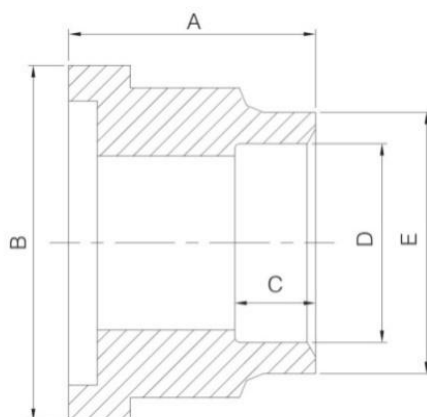

Specification for RC2-G type-P compressor (Horizontal oil separator), Suction/ Discharge flange, Flange sleeve								
Flange Model No.	Flange size	Material and size		Flange sleeve size				
				A	φB	C	φD	φE
Suction flange RC2 -100G-P	2"	Copper	2- 1/8"	50	90	30	55	65
Discharge flange RC2-100G-P		Copper	2"				61.3	74
Discharge flange RC2 -230G-P/RC2-260G-P	2-1/2"	Copper	2- 5/8"	60	110	35	68	77
		Steel	2- 1/2"				77.2	90
Discharge flange RC2 -410G-P/RC2 -470G-P	3"	Copper	3- 1/8"	66	120	45	80.5	90
		Steel	3"				90.2	103
Suction flange RC2-230G-P/RC2-260G-P	4"	Copper	3- 5/8"	76	145	50	93	103
RC2-410G-P/RC2-470G-P		Steel	4"				110	128
Discharge flange RC2-710G-P/RC2-790G-P	5"	Copper	4- 1/8"	80	174	35	106	121
Suction flange RC2-710G-P/RC2-790G-P		Steel	5"	75			135	154

Specification for RC2-T type-P compressor (Horizontal oil separator), Suction/ Discharge flange, Flange sleeve								
Flange Model No.	Flange size	Material and size		Flange sleeve size				
				A	φB	C	φD	φE
Discharge flange RC2-200T-P	2"	Copper	2- 1/8"	50	90	30	55	65
		Steel	2"				61.3	74
Suction flange RC2 -200T-P	2-1/2"	Copper	2- 5/8"	60	110	35	68	77
Discharge flange RC2-230T-P ~RC2-370T-P		Steel	2- 1/2"				77.2	90
Suction flange RC2 -230T-P~RC2-310T-P	3"	Copper	3- 1/8"	66	120	45	80.5	90
Discharge flange RC2-410T-P ~RC2-580T-P		Steel	3"				90.2	103
Suction flange RC2-340T-P ~RC2-580T-P	4"	Copper	3- 5/8"	76	145	50	93	103
Discharge flange RC2-620T-P ~RC2-930T-P		Steel	4"				110	128
Suction flange RC2-620T-P ~RC2-930T-P	5"	Copper	4- 1/8"	80	174	35	106	121
		Steel	5"	75			135	154

Application Limits

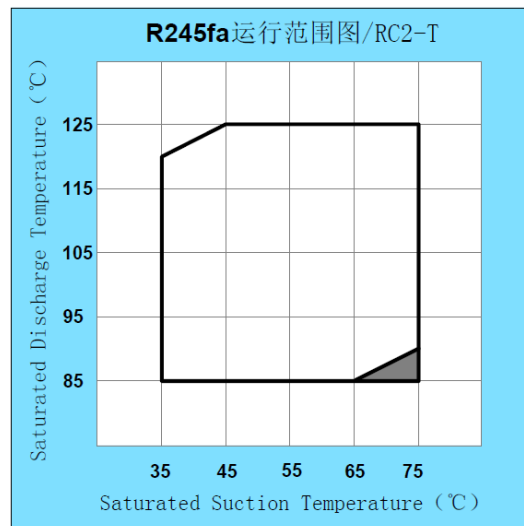
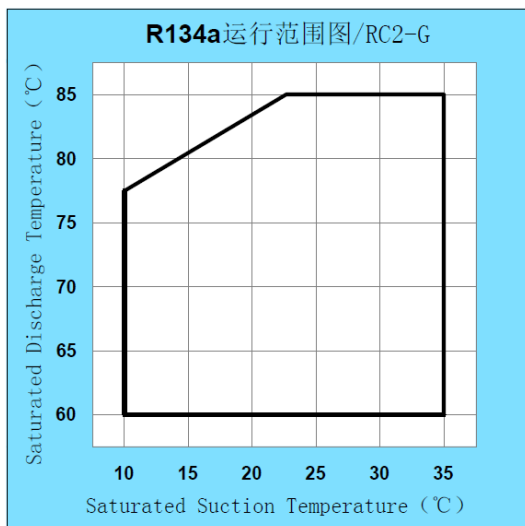

Official website



Official WeChat



Electronic Brochures



上海漢鐘精機股份有限公司
SHANGHAI HANBELL PRECISE MACHINERY CO., LTD.

No.8289, Tingfeng Road, Fengjing Area, Jinshan District, Shanghai, China

TEL: 021-57350280 FAX: 021-51368588

Service Line: 4007702158

P.C.: 201501

http: //www.hanbell.com.cn

SHANGHAI HANBELL PRECISE MACHINERY CO.,LTD.

JINAN BRANCH

No.4 Building, Liando U Valley International Enterprise Port, No. 2222, South Section of Yuqing Road, Changqing District, Jinan, Shandong Prov.

TEL: 0531-85060075 FAX: 0531-85060071

SHANGHAI HANBELL PRECISE MACHINERY CO.,LTD.

NANJING BRANCH

No.95, Gaohu Road, Jiangning District, Nanjing City

TEL: 025-52078091/1/3 FAX: 025-52078090

SHANGHAI HANBELL PRECISE MACHINERY CO.,LTD.

GUANGZHOU BRANCH

No.15 Wenkeng Road Lianwang Industrial Park, Guangzhou, Guangdong Prov.

TEL: 020-34721075 FAX: 020-3472325

SHANGHAI HANBELL PRECISE MACHINERY CO.,LTD.

CHONGQING BRANCH

Building A10, Dongben Industrial Park, No.18, Yu Ma Road, chayuan New District, Chongqing, China

TEL: 023-62611068 FAX: 023-62611069